

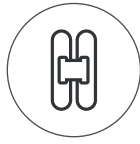

Open, Close, Live



LOCKS



HINGES



CYLINDERS

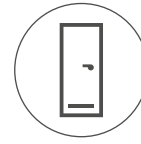

MULTIPOINT LOCK



MADE IN ITALY

## TIMELINE

1947



From the home workshop, Antonio moves to a small plant and his brother Mr. Giorgio Alban starts to cooperate with him in the administrative and commercial area.

AGB was founded in Bassano del Grappa as an artisan workshop by Mr. Antonio Alban who started to produce hinges for heavy steel gates and accessories for wooden doors by following in his father's footsteps, Giacomo Alban.

1953

Alban brothers move the business to a new headquarters in Romano d'Ezzelino. The company is constantly expanding.

1968



The conquest of Italian and foreign markets: AGB gains bigger market share, becoming a leader in many countries.

1980/1990

AGB opens a new highly automated warehouse in Cassola.

2000



AGB opens the third plant in Pove. A high tech department dedicated to the production of high security cylinders.

2005

Giacomo and Alessandra Alban, with the same passion of their uncle Antonio and their father Giorgio, undertake the general management of the company, ensuring continuity to AGB values and mission.

2008



AGB opens 4 branches abroad: AGB SL Logroño (Spain), AGB Italcenter (Serbia), AGB EST PItD (Bulgaria), AGB (China).

2005/2012

AGB extends the production plant in Cassola.

2015



# MADE IN ITALY



ITALIAN  
PRODUCTION



MADE FOR YOU



CREATIVITY  
AND INNOVATION



PARTNERSHIP



DESIGN

## WE ARE MADE IN ITALY

We are made in Italy.  
the company strategy is based on the values of the Italian culture, which is recalled on the production process and marketing choices: Italian production, product customization, passion for research and creativity are the main guidelines to develop the perfect product for each customer.

## WE BELIEVE IN OUR COUNTRY

We produce in our 4 Italian plants in Romano d'Ezzelino, Pove del Grappa and Cassola. For us, quality is in pole position: keeping our know-how in Italy is our secret formula.  
the choice came by the Alban family decision to hold tight their ties with the local community in order to preserve its wellbeing and stability.

## WE DESIGN THE SOLUTION FOR YOU

Knowledge of the International market, qualified product managers for each product range, Italian production controlled step by step, AGbLab Research & development laboratory: these are the strategic choices which allow us to offer personalized solutions for the customer.  
It is a production made for you, dedicated to you.

## WE KEEP INVESTING IN IDEAS AND TECHNOLOGIES

We believe the best of technology and creativity is the perfect mix for a product even more competitive. Excellent results come only from the fusion of ideas, competence and skills. they are guaranteed by certifications given to manufacturing processes and products.  
We love designing, testing and creating new solutions.

## WE HELP YOU TO IMPROVE YOUR PRODUCT

The perfect solution comes by teamwork, where the customer and the supplier are in partnership and they collaborate to improve their performances. We help the customer testing directly his products in our laboratories and sharing the test results with our qualified technicians. our technical promoters are trained to help the customer on technical issues and product development.  
We work with the customer before, during and after the sale.

## WE DESIGN THE SOLUTION FOR YOU

our products are technologically advanced and beautiful, too.  
the continue research brings us to simplify every single product part. the design of each item is minimalist, clear and linear.  
the hardware is not just a structural element anymore, but it's also considered an essential part for the final product design.  
so, it becomes beautiful and can be shown.



### LOCKS

Range of locks for entrance and interior doors, available in many models and for all application types: interior doors, entrance doors, sliding doors, bathroom doors and hotel doors. It is possible to combine them with AGB Scudo and PS cylinders with stainless steel U-shaped reinforced insert and duplicated controlled key. The access control system Opera Bit is perfect for hotels and communities.

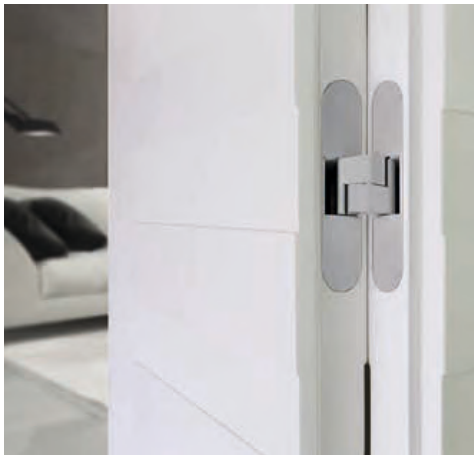

### HINGES

The hinges, normally a secondary element of windows and doors, are instead one of the most important components as they are decisive for the moving. AGB proposes hinges for all types of windows and doors: from simple hinges for wooden frames to up-to-date and complex adjustable hinges, with three possible dimensional adjustments.



### MULTIPOINT LOCKS

The Multipoint locks are the best solution for the closing of entrance and french doors. The contemporaneous fastening on more locking points, with locking cams, hooks and bolts, remarkably improves the door security. Models available: Sicurtop operated by the cylinder, Unitop operated by the handle.



### CYLINDERS

Complete series of European profile security cylinders, all produced in conformity with UNI 9570 standard specifications and certified according with the EN 1303. The SCUDO and PS cylinders provide incremental levels of passive and active security. Non-handed, high-resistance brass and nickel silver keys. TENAX protective rim guard guarantees even higher anti-burglar protection.

# LOCKS

Range of locks for entrance and interior doors, available in many models and for all application types: interior doors, entrance doors, sliding doors, bathroom doors and hotel doors. It is possible to combine them with AGB SCUDO and PS cylinders with stainless steel U-shaped reinforced insert and duplicated controlled key.

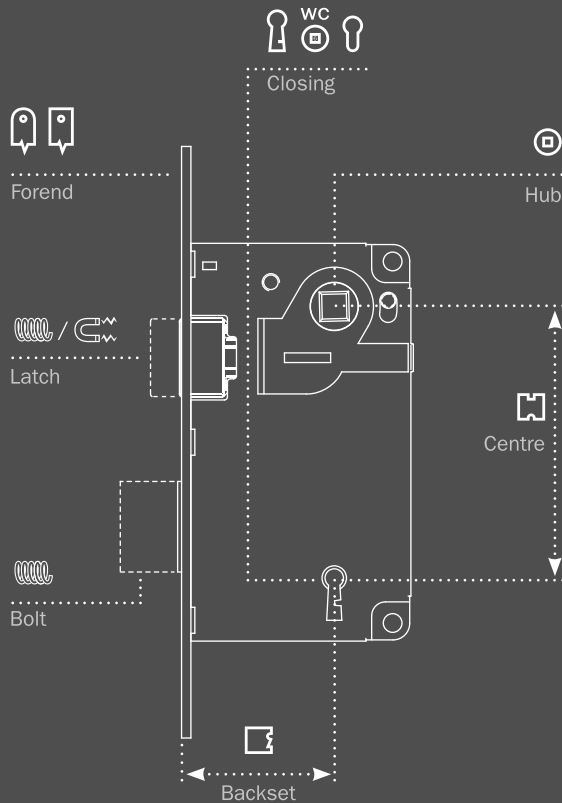

Fire resistance and smoke controlled tests.



CE mark according to EN 12209: requirements and test methods for locks.



Patented product.



Accredited unit.



Accredited unit.



**EASY-FIX XT**  
Traditional design, innovative solutions: surface mounted plate and clip-in cover tray.

## POLARIS 2XT



- 85 mm (U)
- 18 mm
- 60 mm
- 8 mm
- 
- steel

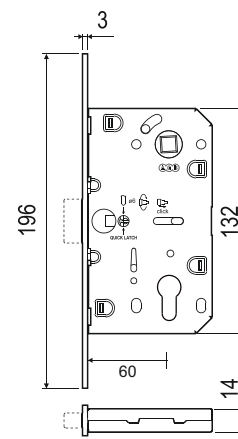

06 Nickel plated







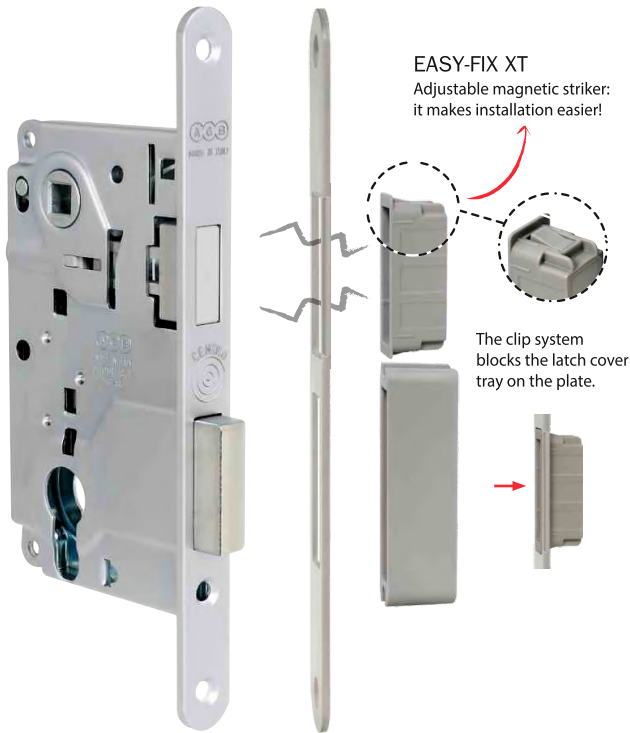

12 Antique brass

Polaris 2XT is a magnetic movement lock. It is particularly suitable for modern internal doors, thanks to its 'lean' look design, certified at the highest grade.



CENTRO FOCUS

-  85 mm 
-  18 mm
-  50 mm
-  8 mm
- 
- steel

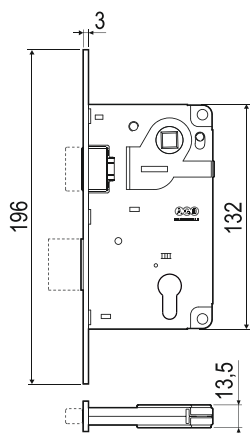

New MEDIAANA EVOLUTION



-  85 mm 
-  18 mm
-  60 mm
-  8 mm
- steel

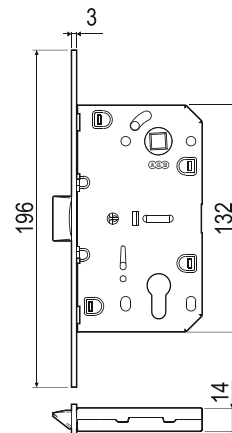



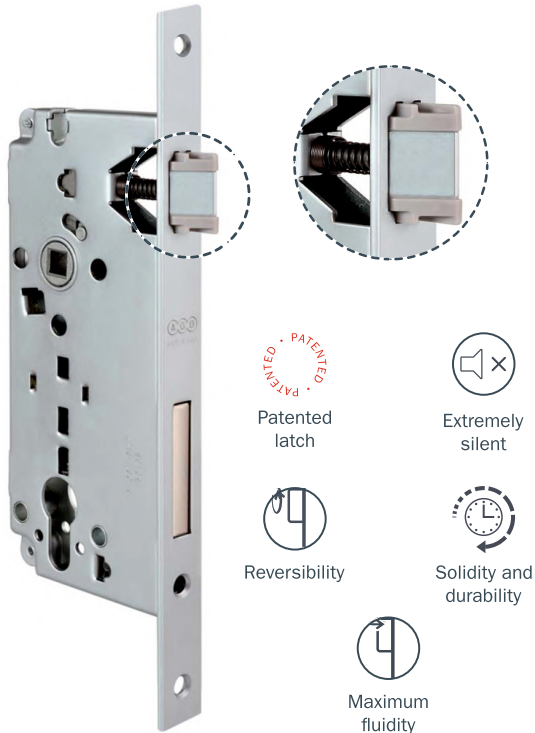

SICUREZZA 2.0



SICUREZZA DEAD LOCK



- 85 mm
- 22 mm
- 45/50/60/70 mm
- 8 mm

steel, brass, stainless steel

Bolt only, without spring latch version also available.

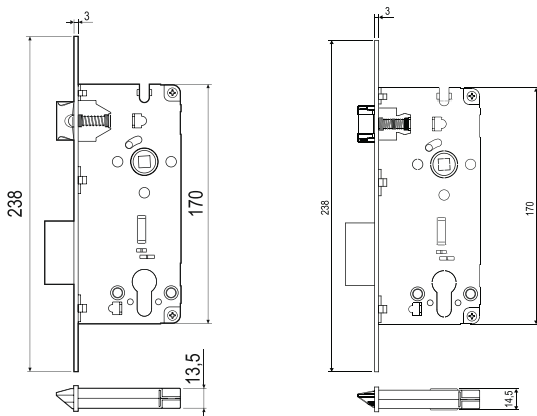

06 Nickel plated



12 Antique brass

- 18 mm
  - 60 / 70mm
- steel

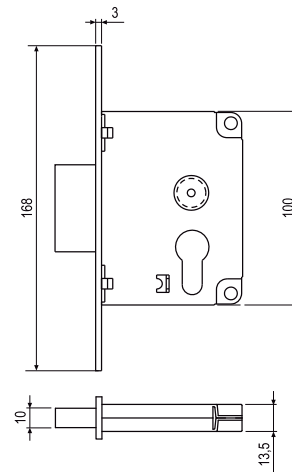

06 Nickel plated





12 Antique brass

The **new patented latch** has been realised co-moulding metal and self-lubricating plastic materials. AGB matched the best qualities of the two materials ensuring **solidity** and **silence** during the closing movement. The 4 lateral guides, in fact, drive the latch movement until it get completely into the lock, ensuring **maximum fluidity**, **smoothness** and noise reduction.



**SICUREZZA SR** *New*

-  22 mm
  -  60 mm
  -  roller latch
- steel, stainless steel

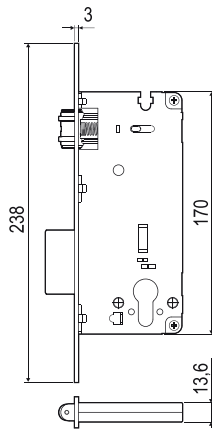

**SCIVOLA TRE**

-  70 mm
  -  18 mm
  -  50 mm
  -  8 mm
- steel

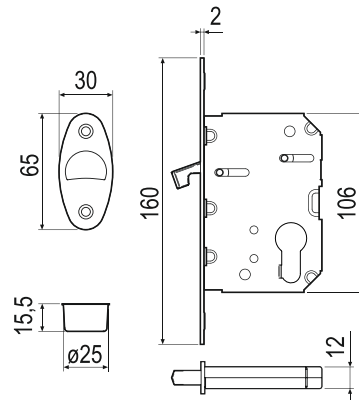



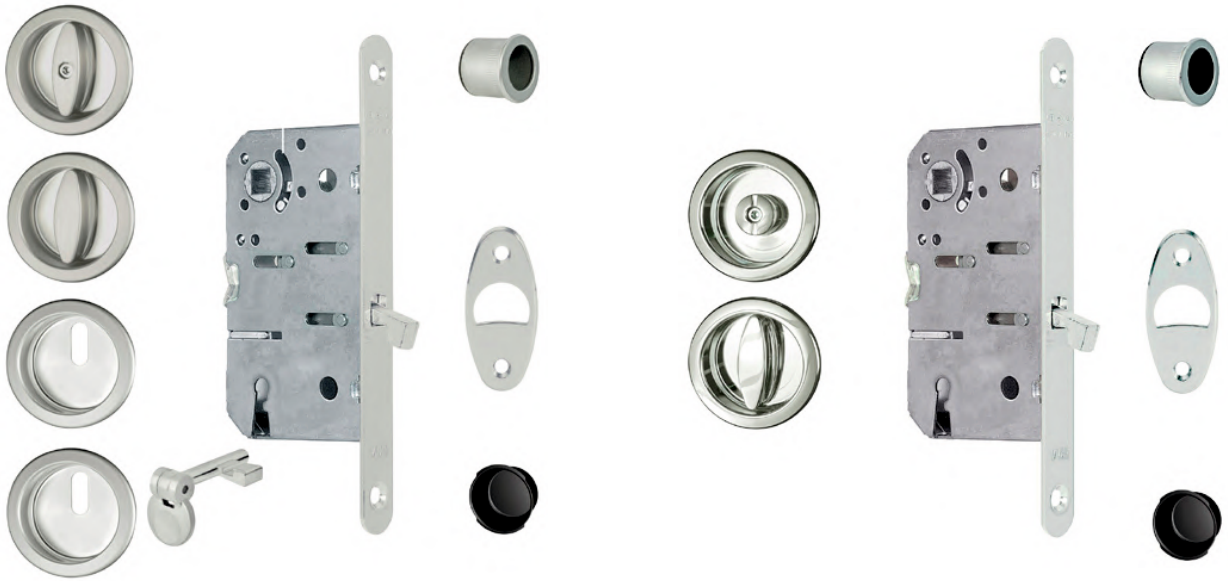

Lock with return hook. Reduced bulk. Thanks to the standardization of the mill hole, Scivola Tre allows to choose the type of closing while executing the set up: cylinder hole, key hole and WC hub.









SCIVOLA TRE - KIT A

-  70 mm
  -  18 mm
  -  50 mm
  -  8 mm
- steel



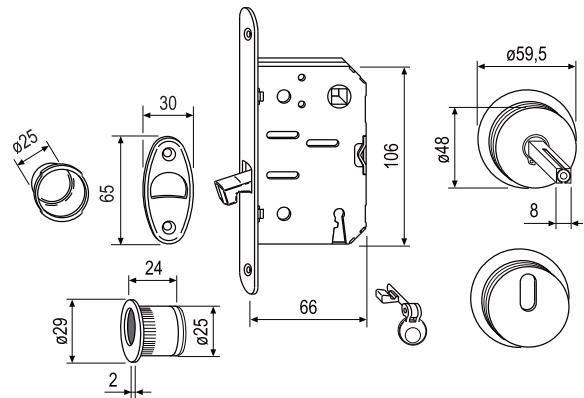
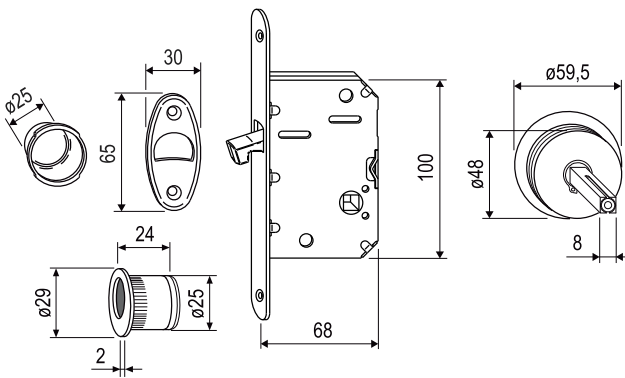

SCIVOLA T - KIT B

-  70 mm
  -  18 mm
  -  50 mm
  -  8 mm
- steel





SCIVOLA TRE - KIT M

-  70 mm
  -  18 mm
  -  50 mm
  -  8 mm
- steel

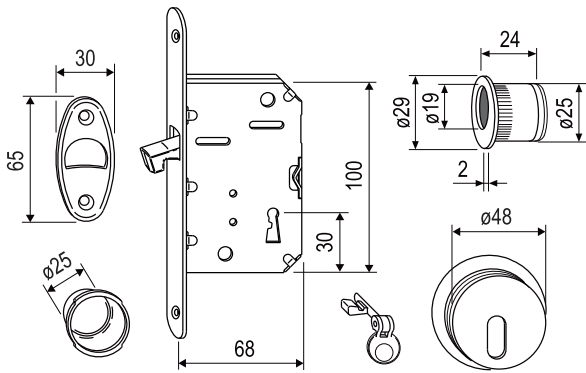

MOD. 701

-  22 mm
  -  50/60 mm
- steel

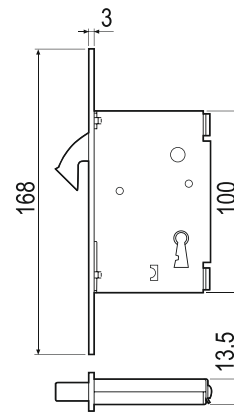

Embedded lock with return hook.



# CONCEALED HINGES

## ECLIPSE

INVISIBLE FROM OUTSIDE,  
IMPROVES THE DOOR DESIGN

AGB introduces the ECLIPSE project: the range of concealed hinges for internal doors combines design, technological functionalities and installation simplicity. This quality has been possible thanks to the knowledge grown up by AGB in 70 years of experience.



ADJUSTMENTS



RANGE



FINISHES



SIMPLICITY OF  
MANAGEMENT  
AND INSTALLATION



Hinge for wood



Hinge for aluminium



Max. extension



EN 1634

Fire resistance and smoke controlled tests.



EN 1935

CE mark according to EN 1935:  
requirements and test methods for hinges.

Frame part Sash part

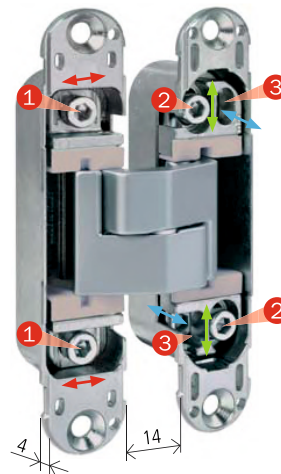

115 mm

14 mm

zamak

## ECLIPSE 3.2



- Concealed hinge for flush doors with or without rebate and aluminium doors, thanks to the 4 mm thickness of the hinge fastening.
- Completely invisible thanks to the reduced dimensions.
- Easy installation: sash and frame parts can be assembled separately during production and joined on site.
- Aluminium flush covers with edges hide every defect on workings.
- Three independent adjustments: pressure adjustment:  $\pm 1$  mm ①, vertical adjustment:  $\pm 2$  mm ②, horizontal adjustment:  $\pm 1,5$  mm ③.

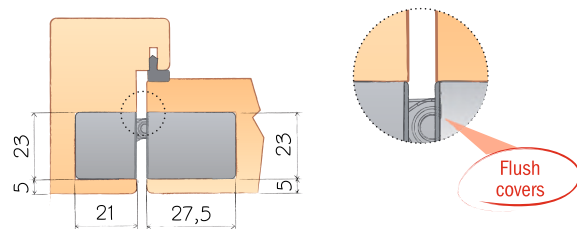

13  
Satin  
nickel



34  
Matt  
chrome



93  
Black





ECLIPSE Models	TECHNICAL INFORMATION						APPLICATIONS			CERTIFICATIONS	
	CAPACITY	ADJUSTMENTS	OPENING	MAX. EXTENSION	COVERS APPLICATION	COVERS APPLICATION	FLUSH DOORS WITH REBATE	FLUSH DOORS WITHOUT REBATE	ALUMINIUM FLUSH DOORS	FIRE AND SMOKE RESISTANT DOORS	EAD 020001-01-0405 EN 1935
3.2	x 3 = 60 kg x 2 = 40 kg	3	180°	14 mm	•	•	•	•	•	30 min	•

# MULTIPOINT LOCK

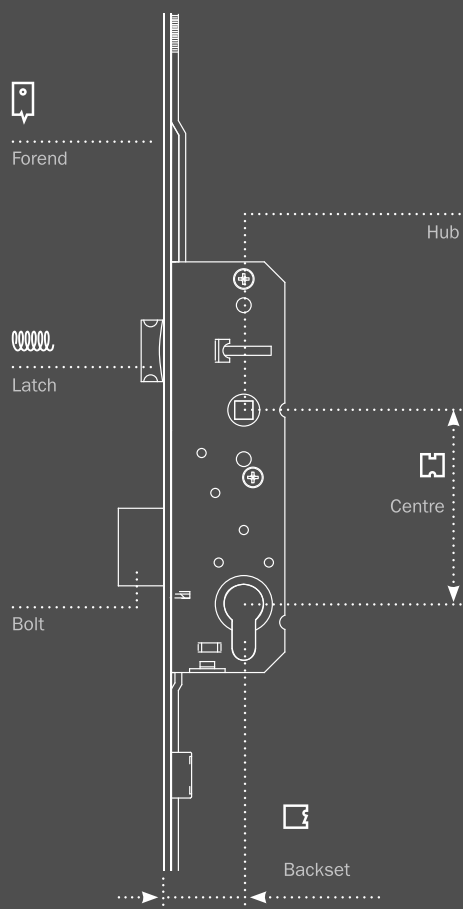
The Multipoint locks are the best solution for the closing of entrance and french doors. The contemporaneous fastening on more locking points, with locking cams, hooks and bolts, remarkably improves the door security. Models available: SICURTOP operated by the cylinder.

SICURTOP is the ideal locking system for entrance and garden doors. It can be installed on wood, PVC or aluminium / wood sashes. The locking points, suitably distributed on the forend, ensure an excellent resistance against break-in attempts. Especially, the patented lock Poseidon, where lower and upper hooks close on opposite directions and avoid the unhinging of the door by means of lifting or removal of the rebate form the frame.



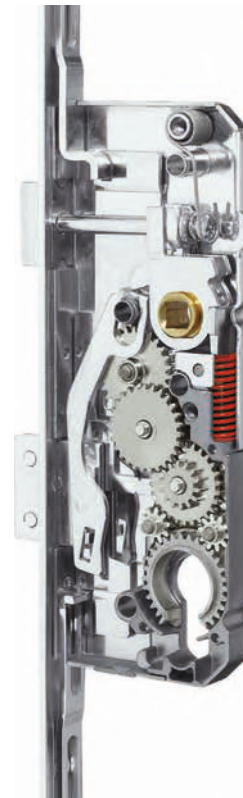

-  Poseidon
-  Bolt + roller cam
-  Telescopic mushroom cam
-  Adjustable roller cam

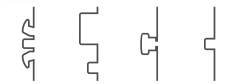

## SICURTOP

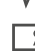

- Lock with several locking points and cold pressed steel gears.
- The cylinder operates bolt and locking points.
- Smoothness and security closing movement with 2 throws.
- Compatible with terminals and extensions.
- Compatible with protective rim guard Tenax.

-  85 mm
-  20 mm
-  70 mm



## POSEIDON



- Patented lock for a maximum antiburglar security.
- Two opposite facing hooks and central bolt guarantee solidity and door security.



SKG certification, equivalent to the 2<sup>nd</sup> resistance class according to the regulation EN 1627.

SICURTOP POSEIDON  
MULTIPOINT LOCK

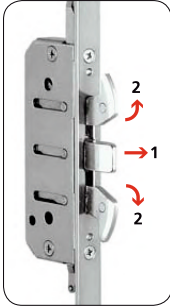

Intermediate locking point

**Poseidon**

Patented lock where hooks and bolts are made of solid steel blades in order to guarantee maximum strength and security to the balcony door.



Central lock

**Central locking point with spring latch bevelled on both sides**

Thanks to its special design, it always guarantees the perfect closing of the door.

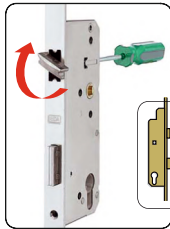

The spring latch is easy to reverse using a common screwdriver.

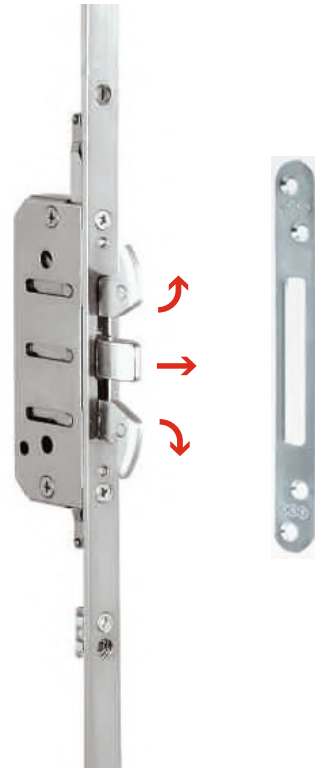
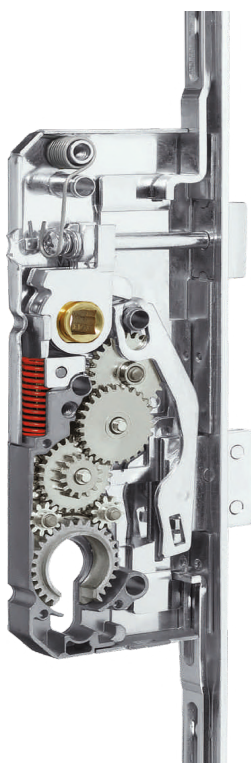
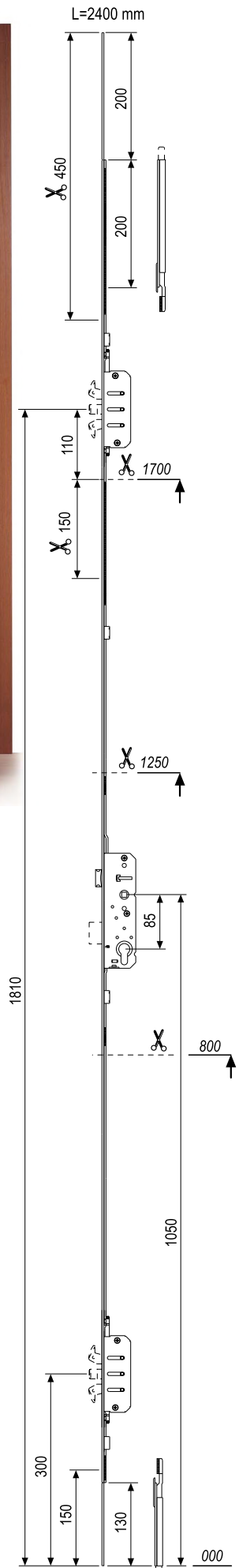
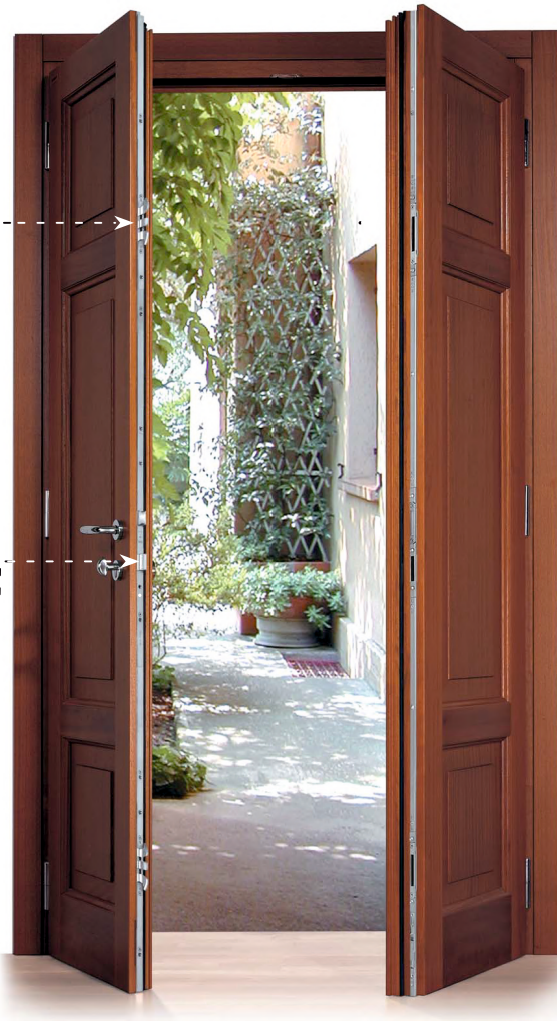



# CYLINDERS

AGB offers a complete range of cylinders and accessories to satisfy all the requests about security and access control, giving the perfect solution for each kind of installation. AGB cylinders are completely made in Italy, in the dedicated plant in Pove del Grappa. Every cylinder exceeded the strict tests required by the European regulation EN 1303, guaranteeing security, quality and long-lasting durability.

## EXTREME PRECISION



Maximum precision



Attention to details



High quality

## AUTOMATED ASSEMBLY



Automated production



Express delivery



Customisation

## AUTOMATIC TESTS



Strict tests in AGBLab



Automated control



Tested one by one

## AGB CYLINDERS A warranty of security



High bumping resistance



Hardened steel anti-drill pins



U-shaped reinforcement

## AGB KEYS Billions of combinations



Controlled duplication



Ergonomic grip



Key system management



Fire resistance and smoke controlled tests.



Accredited unit.



Security and quality certification of the imported products in Russia.



Dutch certification on the anti-burglar resistance.

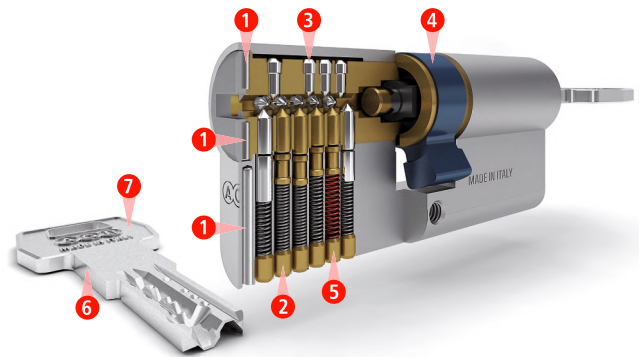

## 5000 PS

- 3 anti-drill pins in steel on each side. ①
- 6 active pins ② and 9 passive pins ③ for a wide range of coding.
- Anti-pull cam in sintered steel. ④
- High resistance to bumping, certified according with ICIM 70R009. ⑤
- 5 flat reversible keys with long neck that are resistant to torsion. ⑥
- Possibility to personalise the grip with many different coloured covers. ⑦
- Available with double function (2 keys inserted in the same time).
- Suitable for fire and smoke resistant doors.

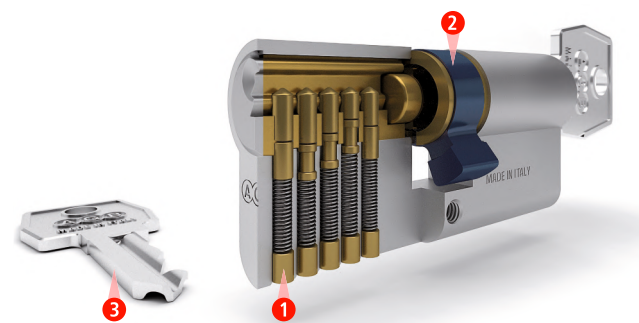



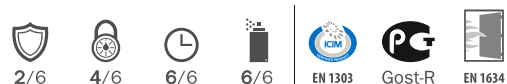

## MOD. 600

- 4 or 5 pins in brass for the coding. ①
- Anti-pull cam in sintered steel. ②
- 3 profiled nickel plated brass keys. ③
- Wide possibility of existing coding.
- Suitable for fire and smoke resistant doors.





**CYLINDERS RANGE**

	5000 PS	MOD. 600
 key - key		
 half - key		
 knob - key		
 knob - emergency		
 half - knob		

**SYSTEMS**

**KA**

Key alike system

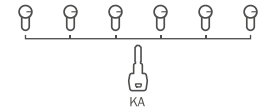

**MK**

Master key system

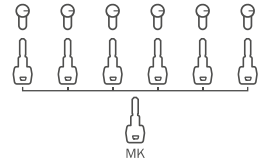

**GMK**

General master key system

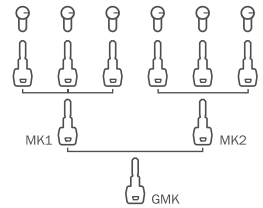

**CC**

Central cylinder system

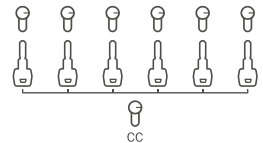

**CCMK**

Central cylinder system and master key

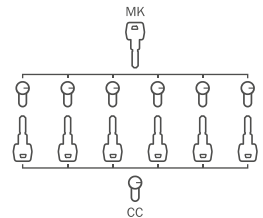

**FINISHES RANGE**



01

Polished Gold



12

Antique brass



13

Satin nickel plated



30

Polished Chrome



F9

Black titanium



84

Matt black

**CUSTOMISATION** All the AGB cylinders can be personalised according to your needs.

Tailor-made cylinders... for all the doors!



Up to 175 mm on each side, at 5 mm intervals

Lever Bolt - 16 mm Forend

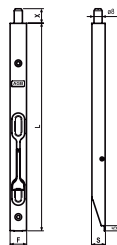
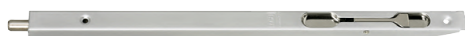

**PASS KEY**



The Pass key is available on request: the pass key is deactivated automatically when customer uses one of his keys for the first time. For availability, please make reference to the price list in force.

